

Effective. Ergonomic. Economical.

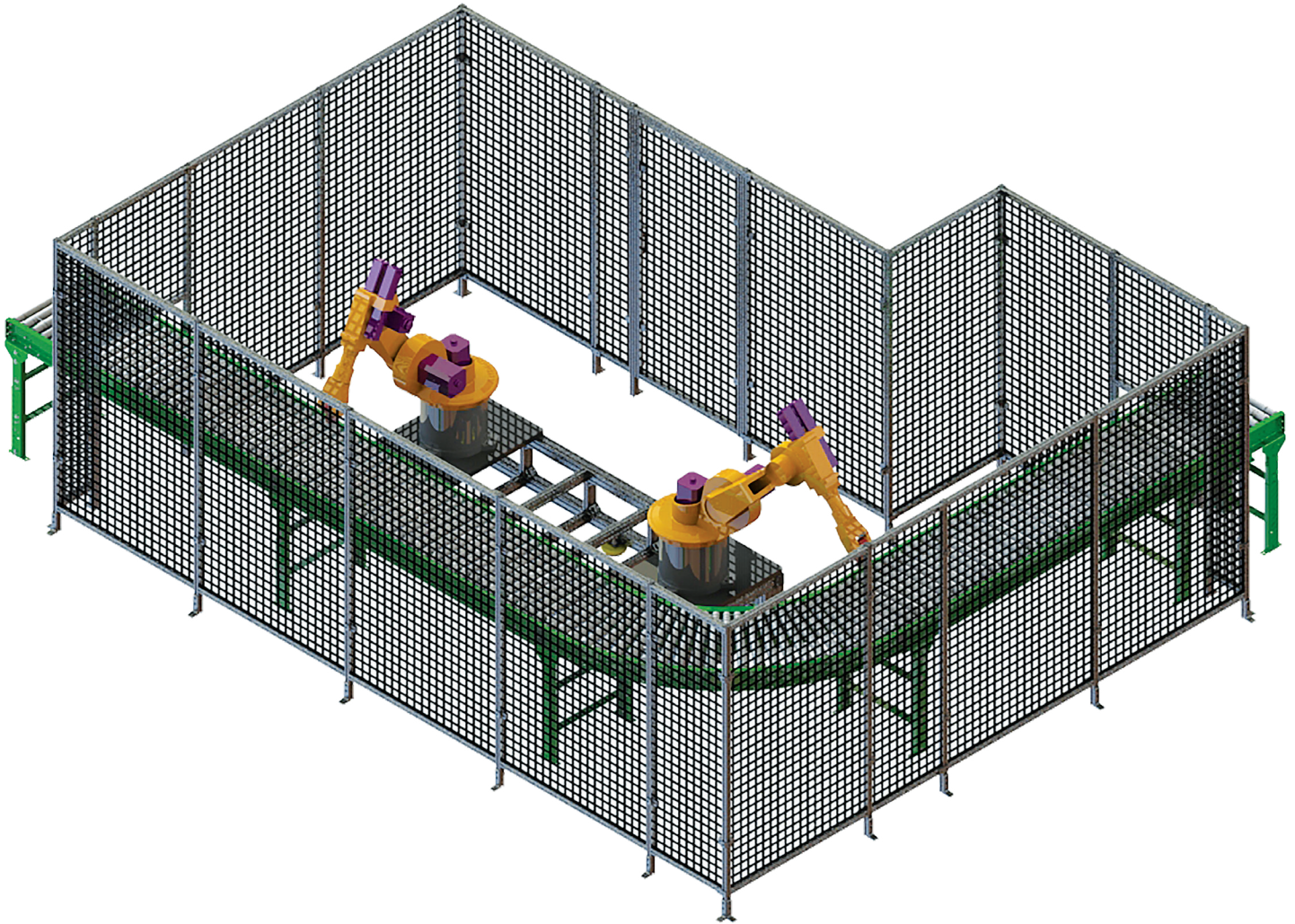

Pre-Engineered Safety Guarding



Online Pricing Guide

1 (800) 817-0617

www.parco-inc.com

REV 2017-1

PARCO, INC.

T-SLOT PRE-ENGINEERED SAFETY GUARDING CATALOG
Non-magnetic. Aesthetically pleasing. Easy to configure & re-configure. No welding = no heat stress or warping.

Simple & Flexible Safety Guarding

Over 15 years of building custom products from T-Slotted Aluminum Extrusions means you'll find the best solutions for your machine and perimeter guarding at Parco, Inc.

Parco's pre-engineered safety guarding offers a wide range of solutions for machine, robotic, welding cells, MRO parts area, automated lines, and much more. The P.E.S.G. will create a safe physical barrier between moving parts and your employees. It also meets OSHA and ANSI requirements for safety.

Our t-slotted aluminum extrusion products are utilized for the framing on all of our fencing units. We then use PVC-coated wire mesh or clear polycarbonate panels to construct the barrier wall. These products together make a sturdy, durable, aesthetically pleasing, and flexible finished product. The components are available in fractional and metric measurements, meaning they are fully compatible with most existing products on the market.

With Parco's Pre-Engineered Safety Guarding, the majority of the work is done for you. Simply measure the outline of the area you need to guard and decide what style you need. Add up the LNFT with your door options and in seconds you have the price for your system. Parco can have your product to you within days. The P.E.S.G is easy to install too. An average 14" x 18" perimeter guard will only take approximately 3-4 hours to fully install on your plant floor. This saves you from a lengthy, unproductive downtime.

Parco has built and designed hundreds of guarding units that keep employees safe in their workplace. Our capabilities include 50 years of combined experience from our design and manufacturing departments, helping you get the guarding or fencing unit that you need. We have a 100% satisfaction guarantee on all of our products. From designing your partition system, to the machining and delivery of your pre-assembled unit, no one does it faster or better than us.

Simply Pick the Style That Best Fits Your Application...

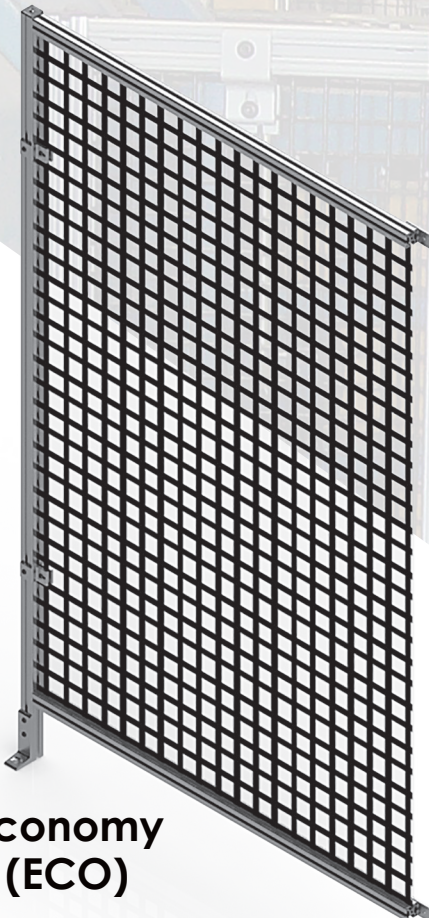

**Economy
(ECO)**

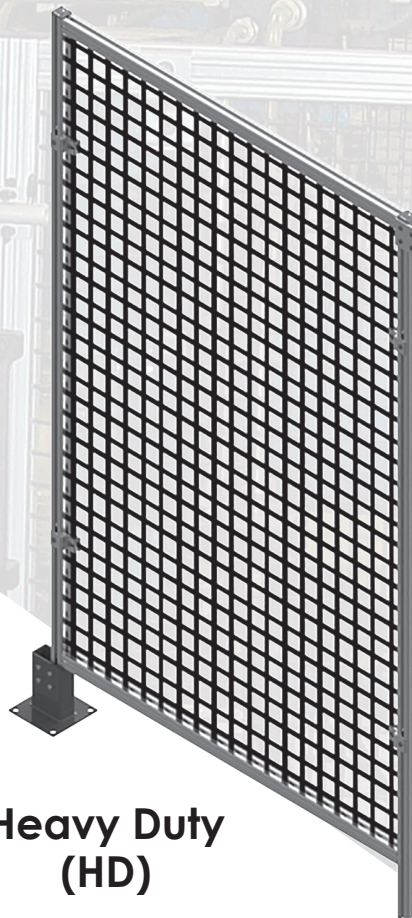

**Heavy Duty
(HD)**

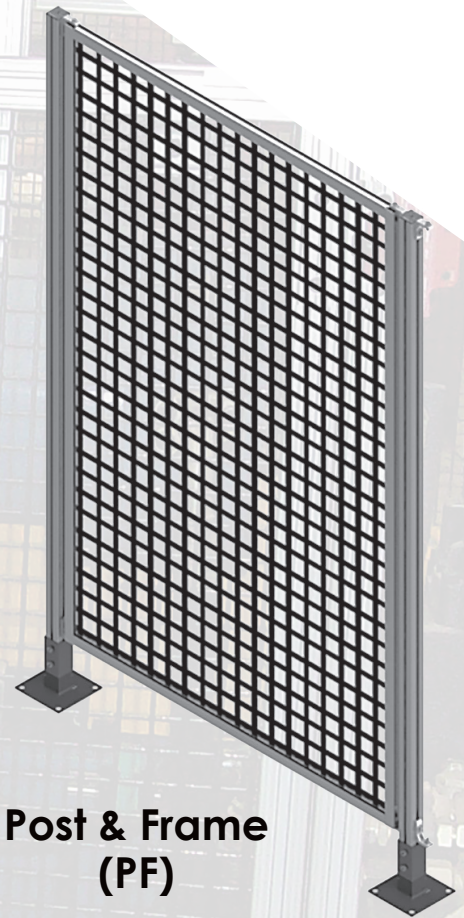

**Post & Frame
(PF)**

Build & Price Your P.E.S.G In 5 Easy Steps

- 1 Get the perimeter dimensions by measuring around the unit you want to guard. Don't forget to add space so maintenance workers can service the machine, if needed.
- 2 Select the style of safety guarding that best suits your needs.
Economy = ECO; Heavy Duty = HD; Post & Frame = PF
- 3 Add up your total - LNFT x Style = Total Guard Cost
- 4 Choose your door if necessary.
Economy = ECO; Heavy Duty = HD; Post & Frame = PF
- 5 Add the door cost to your total guard cost to get your final sum.

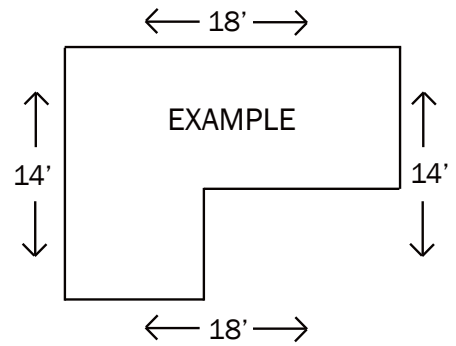

Total perimeter guard dimensions = 64 LNFT

In example:

<u>TOTAL Perimeter Dimension</u>		<u>Style of Guarding</u>	=	Total	+	<u>Optional Door</u>	=	GRAND TOTAL*
64 LNFT	x	ECO-BW				ECO-BW		

*See last two pages for actual pricing information

THE QUICKEST SAFETY GUARD TO PRICE AND INSTALL IN THE INDUSTRY!

To order, simply send in an overhead view of your layout with the measurements and any details for door location and/or conveyor openings in fencing along with your chosen style of guarding.

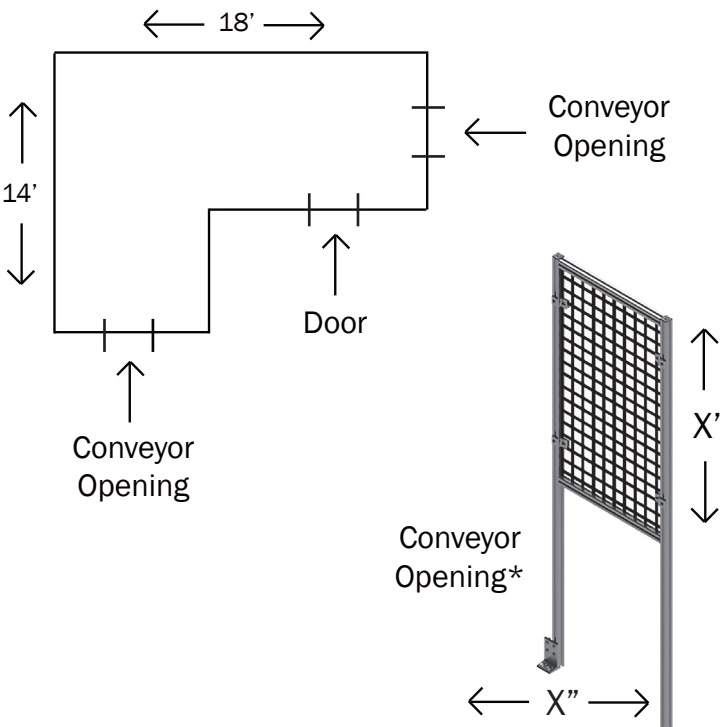

*Conveyor opening size and height will depend on your provided measurements.

Economy Guarding

The Economy Framing System is designed for the price conscious consumer. They are solid, safe panels that are aesthetically pleasing and fully modular. Using the pre-engineered panels of varying heights and widths will allow you to quickly and easily put together your safety guarding, meaning you can save money on installation costs. We use our 1.5" x 1.5" structural aluminum framing for this system.

Wire Mesh & Polycarbonate Panel Options

Heights
60" or 80"

Widths
12"
24"
36"
48"
60"
72"
84"

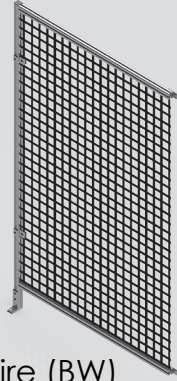

Black Wire (BW)
1 x 1" black PVC coated wire mesh

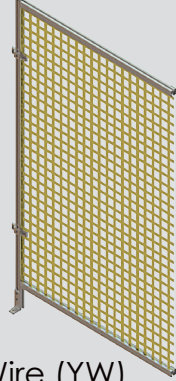

Yellow Wire (YW)
1 x 1" yellow PVC coated wire mesh

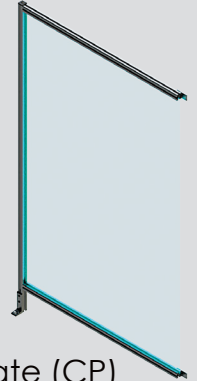

Clear*
Polycarbonate (CP)
3/16" Clear Polycarbonate

*Note: Clear Polycarbonate appears blue in catalog for viewing purposes only. Actual product is truly clear.

Door Options

All door options will match the chosen panel option by default unless specified otherwise. Custom door options are available by request.

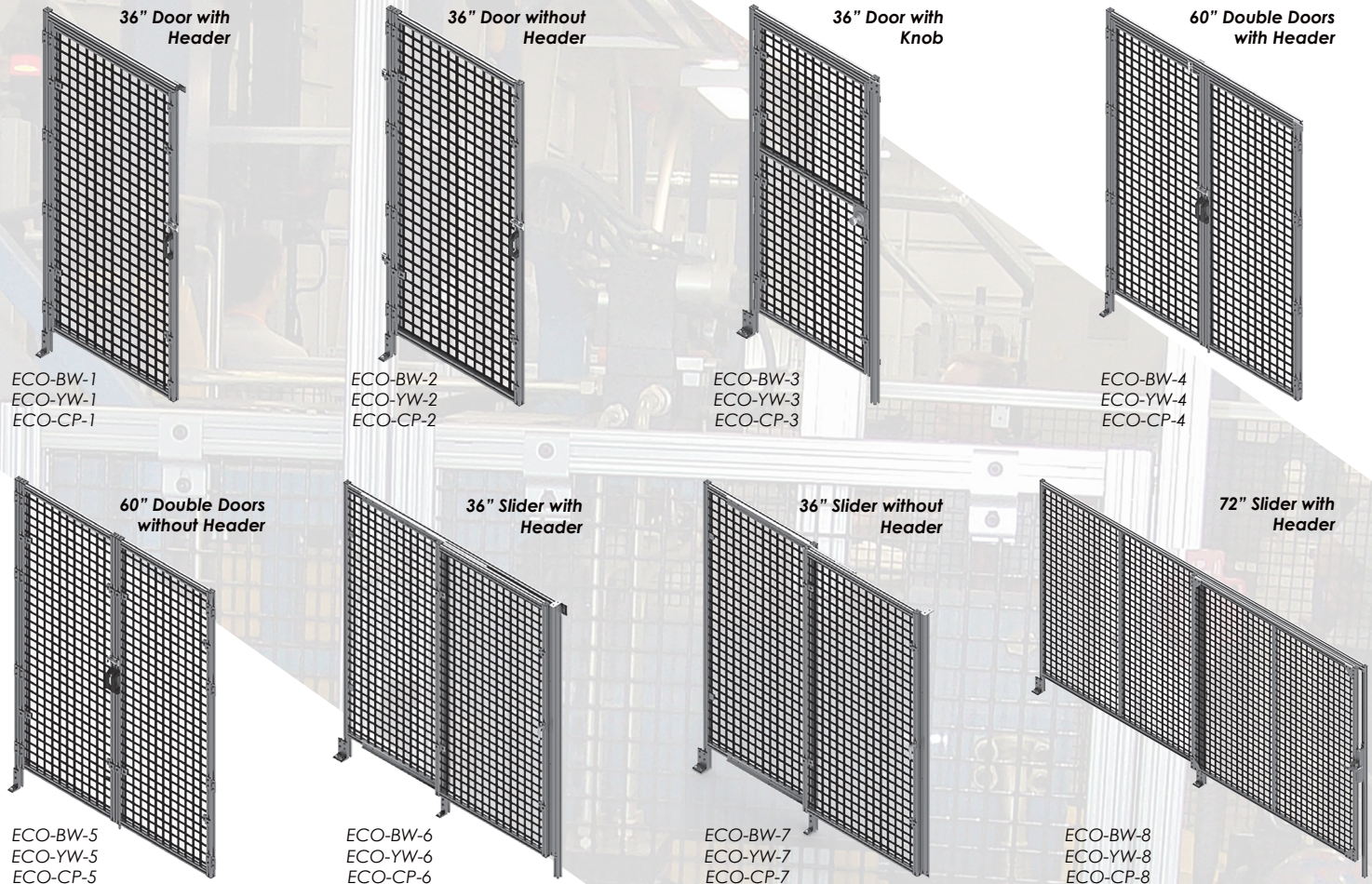

Visit www.parco-inc.com to order or to view our full product catalog

Economy Assembly Guide

Step 1: Panels will be stacked. Remove panels from stack and begin by connecting two panels together to form a corner. Slide feet onto extrusion and tighten bolts.

Step 2: Attach fasteners to extrusion and connect next panel.

Step 3: Connect your doors where necessary. Continue around your unit until your safety guard is complete.

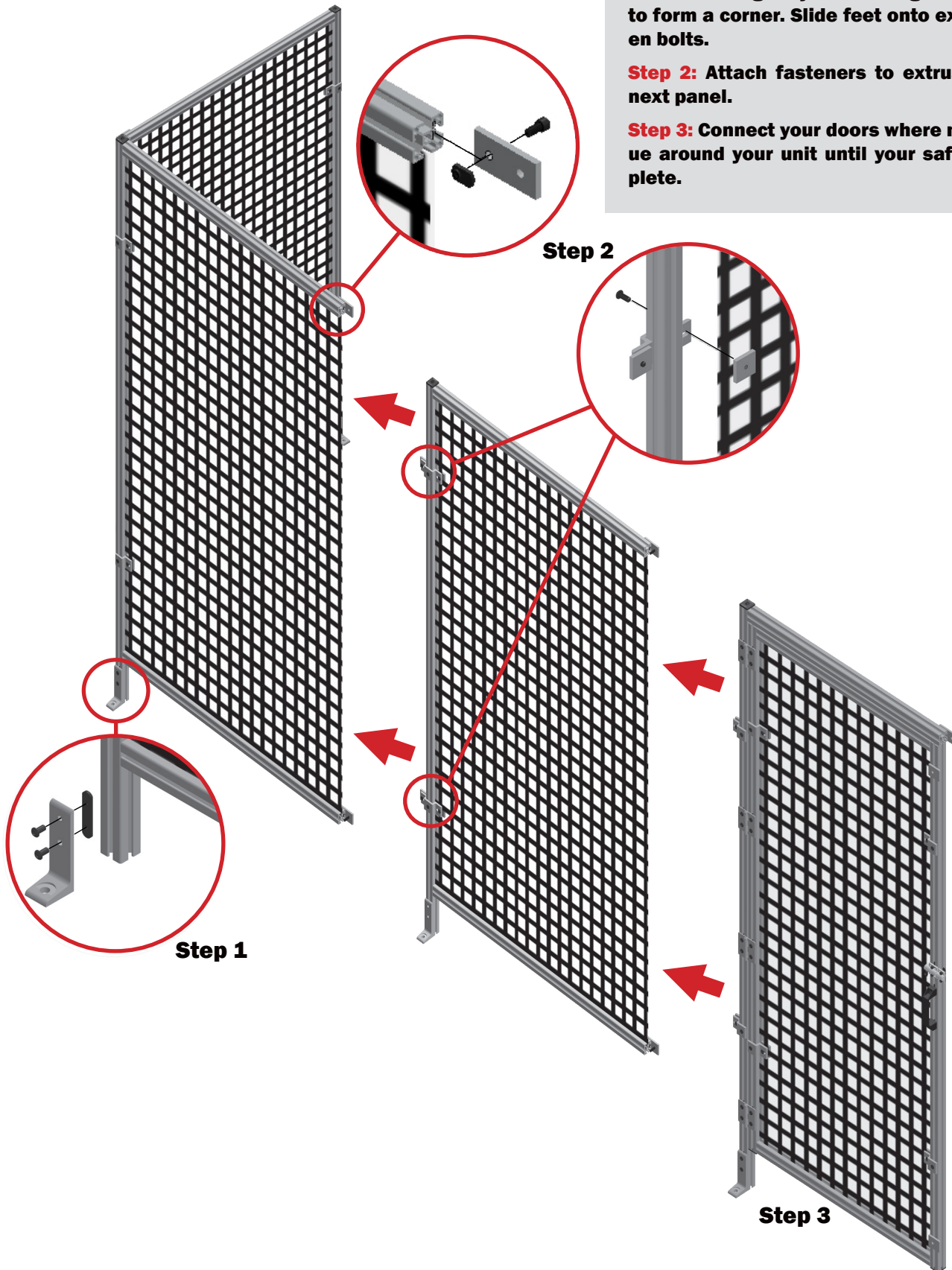

Heavy Duty Guarding

The HD guarding system is our quickest to install and our strongest. The HD system utilizes the same safe, strong T-slotted aluminum extrusions that allow for wire mesh or polycarbonate panels. Hinges, handles, and leveling can also be easily added to the structure. The HD guarding uses full-frame panels that simply slide into the foot of the panel next to it. Just add on a joining plate and you're on to the next section. We use our 1.5" x 1.5" structural aluminum framing for this system.

Wire Mesh & Polycarbonate Panel Options

Heights
60" or 80"

Widths
12"
24"
36"
48"
60"
72"
84"

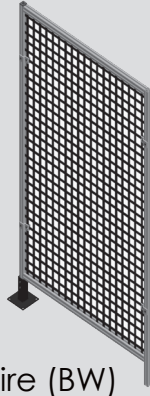

Black Wire (BW)
1 x 1" black PVC coated wire mesh

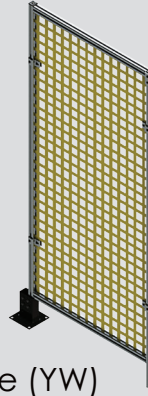

Yellow Wire (YW)
1 x 1" yellow PVC coated wire mesh



Clear* Polycarbonate (CP)
3/16" Clear Polycarbonate

Door Options

*Note: Clear Polycarbonate appears blue in catalog for viewing purposes only. Actual product is truly clear.

All door options will match the chosen panel option by default. Custom door options are available by request.



36" Door with Header

HD-BW-1
HD-YW-1
HD-CP-1



36" Door without Header

HD-BW-2
HD-YW-2
HD-CP-2



36" Door with Knob

HD-BW-3
HD-YW-3
HD-CP-3

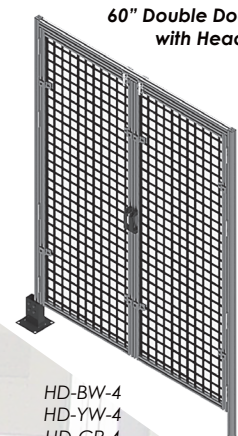

60" Double Doors with Header

HD-BW-4
HD-YW-4
HD-CP-4

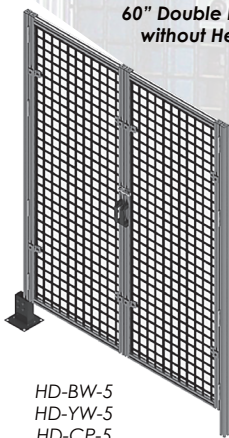

60" Double Doors without Header

HD-BW-5
HD-YW-5
HD-CP-5

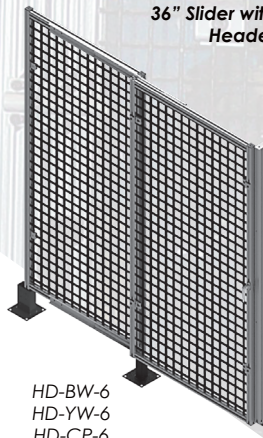

36" Slider with Header

HD-BW-6
HD-YW-6
HD-CP-6

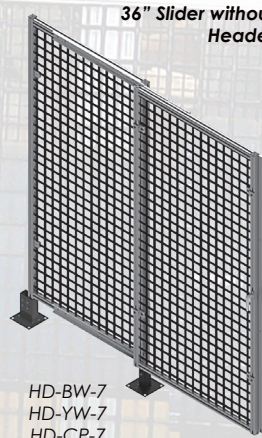

36" Slider without Header

HD-BW-7
HD-YW-7
HD-CP-7

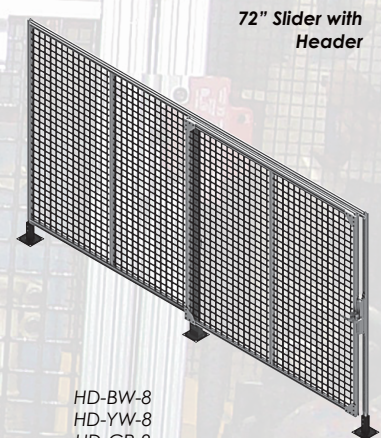

72" Slider with Header

HD-BW-8
HD-YW-8
HD-CP-8

Heavy Duty Assembly Guide

Step 1: Panels will be stacked. Remove panels from stack and begin by connecting two panels together to form a corner. Slide extrusion into feet and tighten bolts.

Step 2: Place the safety guard into the foot of the panel next to it.

Step 3: Slide joining plates into the t-slot of the guard.

Step 4: Install end cap on top of units and continue to next section, adding doors when necessary. Repeat until guard is complete.

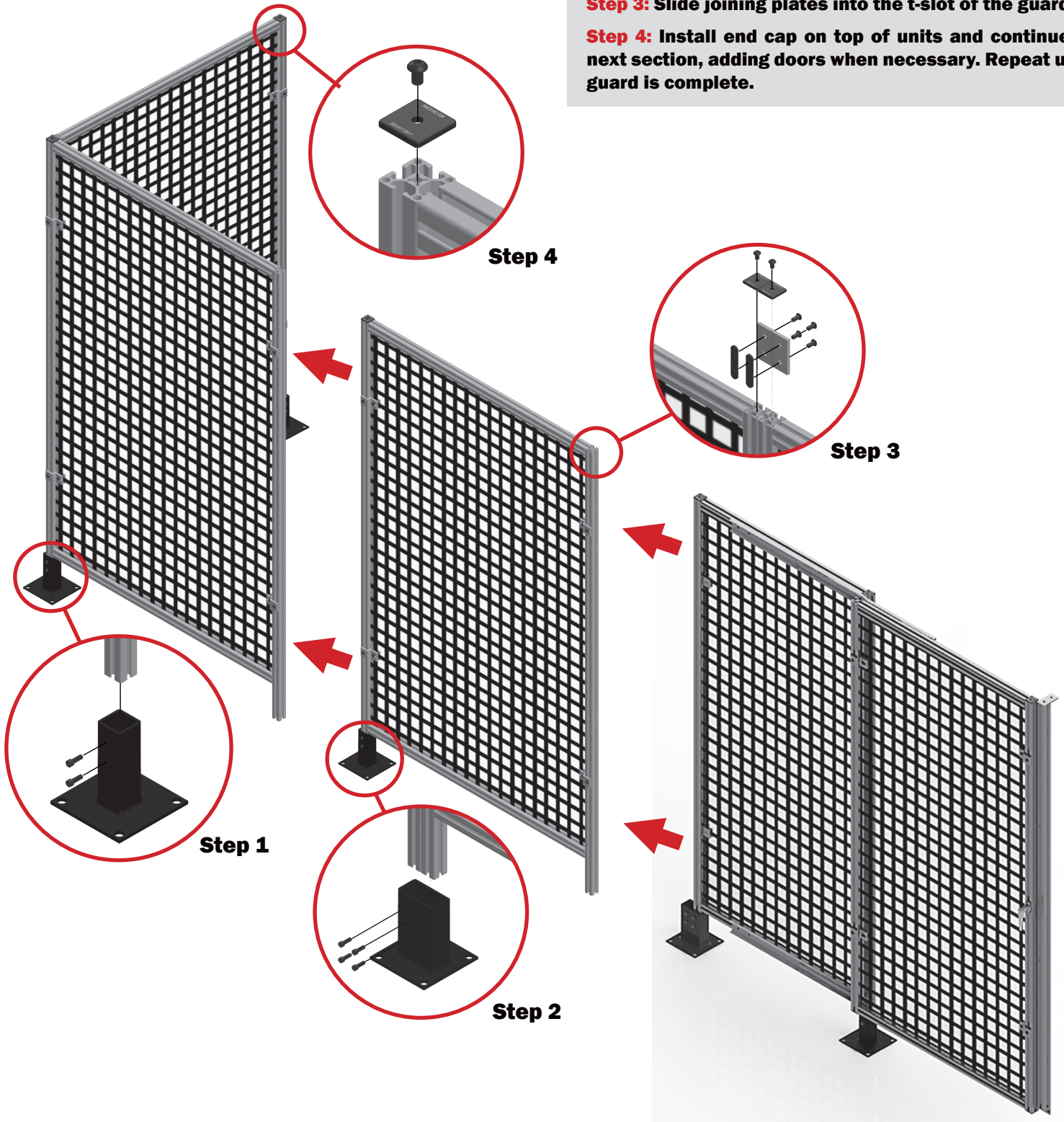

Post & Frame Guarding

Parco's post and frame guarding is the taller guarding option. The post and frame system is perfect for use as part cages, machine enclosures, perimeter safety guards, fencing barriers, and as robotic guarding. The T-slotted aluminum extrusions create an upright for the wire and polycarbonate panels and allow for frame to floor hardware to strongly secure the structure to your floor. We use our metric 45mm x 45mm structural aluminum framing or out 30mm x 30mm structural aluminum framing for this system.

Mesh & Polycarbonate Panel Options

Heights

40"
60"
80"
84"
103"

Widths

12"
24"
36"
48"

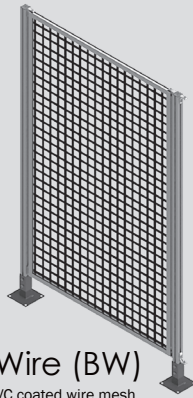

Black Wire (BW)
1 x 1" black PVC coated wire mesh

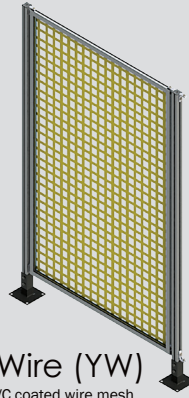

Yellow Wire (YW)
1 x 1" yellow PVC coated wire mesh

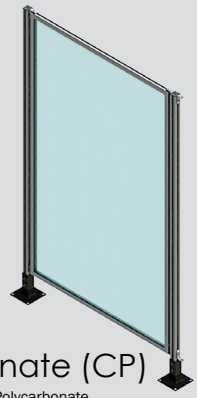

Clear*
Polycarbonate (CP)
3/16" Clear Polycarbonate

*Note: Clear Polycarbonate appears blue in catalog for viewing purposes only. Actual product is truly clear.

Door Options

All door options will match the chosen panel option by default. Custom door options are available by request.



36" Door with Header

PF-BW-1
PF-YW-1
PF-CP-1

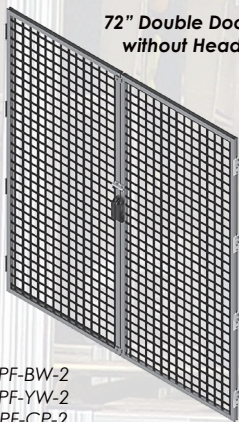

72" Double Doors without Header

PF-BW-2
PF-YW-2
PF-CP-2

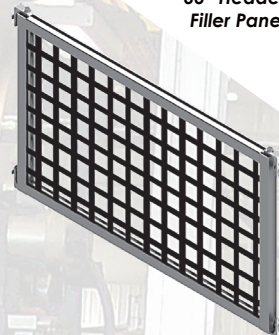

36" Header Filler Panel

PF-BW-3
PF-YW-3
PF-CP-3

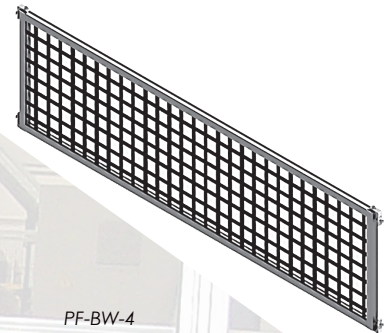

72" Header Filler Panel

PF-BW-4
PF-YW-4
PF-CP-4

ALL OF OUR SAFETY FENCING MEETS OR EXCEEDS OSHA AND ANSI REQUIREMENTS. OUR POST & FRAME GUARDING WILL ALSO MEET NAAMS STANDARDS. PARCO INC. IS COMMITTED TO PROVIDING THE HIGHEST QUALITY PRODUCTS AT AFFORDABLE PRICING AND QUICK DELIVERIES AS WELL AS HELPING YOU TO KEEP YOUR WORKPLACE AS SAFE AND PRODUCTIVE AS POSSIBLE.

CUSTOM SOLUTIONS ARE AVAILABLE UPON REQUEST.

Post & Frame Assembly Guide

Step 1: Start with a corner by locating the correct upright and sliding a steel foot onto it.

Step 2: Keeping the panel at an angle, place the frame panel into the bracket at the bottom of the upright.

Step 3: Move frame to top bracket and bolt in place.

Step 4: Continue to next section and add doors where necessary until guard is complete.

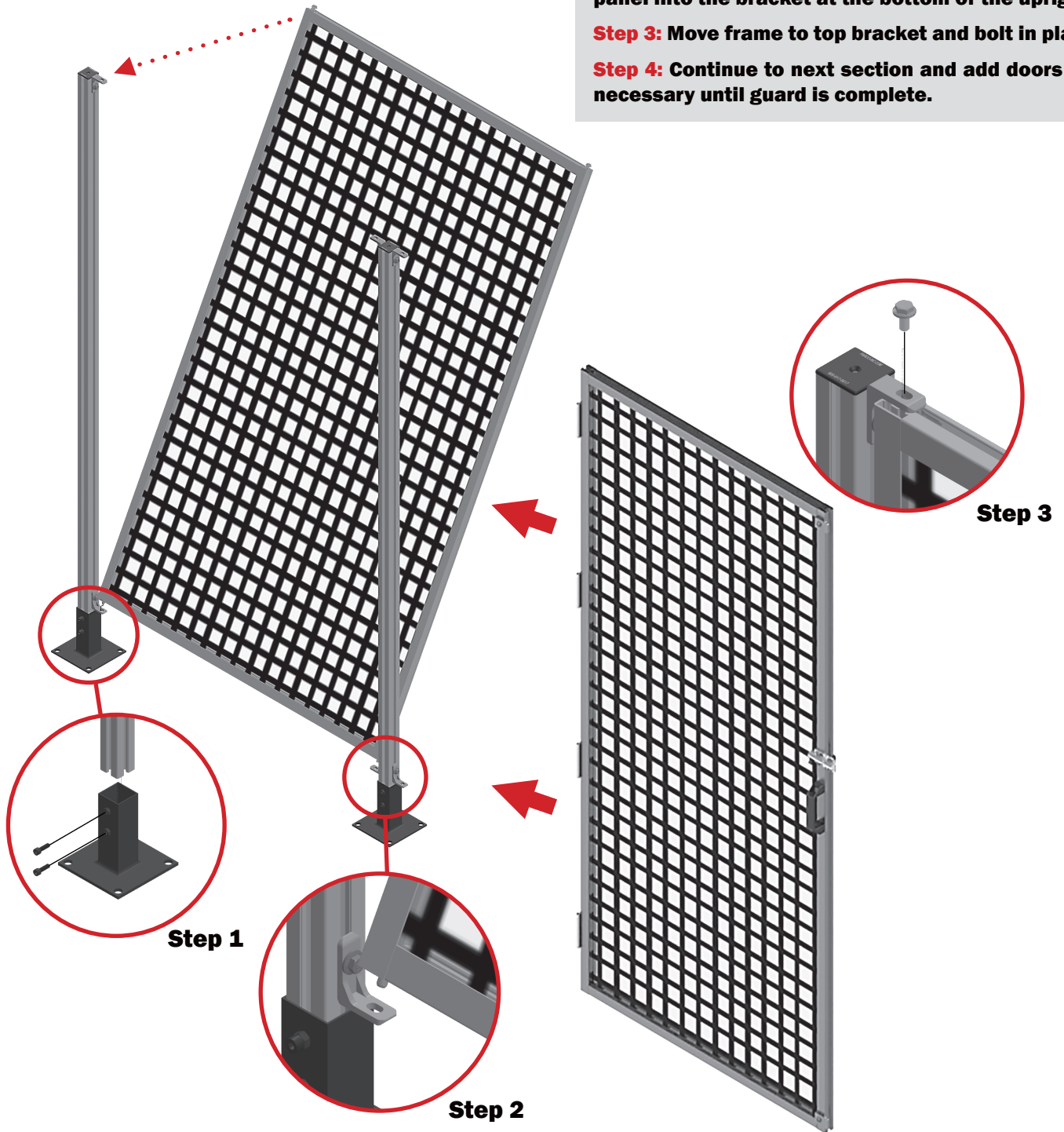

Pre-Engineered Machine Safety Guarding Pricing*

*Note: Parco, Inc. makes constant improvements to its products and therefore reserves the right to change specifications and pricing without notice.

Economy (ECO) Panel Pricing by LNFT

Panel	60"	80"
Black Wire Mesh (BW)	\$66	\$73
Yellow Wire Mesh (YW)	\$66	\$73
Clear Polycarbonate (CP)	\$85	\$99

Economy (ECO) Door Pricing

Door	60"	80"
36" Door with Header	ECO-BW-60-1 - \$220 ECO-YW-60-1 - \$220 ECO-CP-60-1 - \$191	ECO-BW-80-1 - \$233 ECO-YW-80-1 - \$233 ECO-CP-80-1 - \$205
36" Door Without Header	ECO-BW-60-2 - \$204 ECO-YW-60-2 - \$204 ECO-CP-60-2 - \$175	ECO-BW-80-2 - \$218 ECO-YW-80-2 - \$218 ECO-CP-80-2 - \$190
36" Door with Knob	ECO-BW-60-3 - N/A ECO-YW-60-3 - N/A ECO-CP-60-3 - N/A	ECO-BW-80-3 - N/A ECO-YW-80-3 - N/A ECO-CP-80-3 - N/A
60" Double Doors with Header	ECO-BW-60-4 - \$373 ECO-YW-60-4 - \$373 ECO-CP-60-4 - \$324	ECO-BW-80-4 - \$396 ECO-YW-80-4 - \$396 ECO-CP-80-4 - \$347
60" Double Doors Without Header	ECO-BW-60-5 - \$336 ECO-YW-60-5 - \$336 ECO-CP-60-5 - \$286	ECO-BW-80-5 - \$358 ECO-YW-80-5 - \$358 ECO-CP-80-5 - \$310
36" Slider with Header	ECO-BW-60-6 - \$688 ECO-YW-60-6 - \$688 ECO-CP-60-6 - \$699	ECO-BW-80-6 - \$696 ECO-YW-80-6 - \$696 ECO-CP-80-6 - \$698
36" Slider Without Header	ECO-BW-60-7 - \$531 ECO-YW-60-7 - \$531 ECO-CP-60-7 - \$541	ECO-BW-80-7 - \$640 ECO-YW-80-7 - \$640 ECO-CP-80-7 - \$641
72" Slider with Header	ECO-BW-60-8 - \$1548 ECO-YW-60-8 - \$1548 ECO-CP-60-8 - \$1481	ECO-BW-80-8 - \$1574 ECO-YW-80-8 - \$1574 ECO-CP-80-8 - \$1514

Heavy Duty (HD) Panel Pricing by LNFT

Panel	60"	80"
Black Wire Mesh (BW)	\$85	\$93
Yellow Wire Mesh (YW)	\$85	\$93
Clear Polycarbonate (CP)	\$103	\$118

Heavy Duty (HD) Door Pricing

Door	60"	80"
36" Door with Header	HD-BW-60-1 - \$172 HD-YW-60-1 - \$172 HD-CP-60-1 - \$141	HD-BW-80-1 - \$191 HD-YW-80-1 - \$191 HD-CP-80-1 - \$159
36" Door Without Header	HD-BW-60-2 - \$157 HD-YW-60-2 - \$157 HD-CP-60-2 - \$126	HD-BW-80-2 - \$176 HD-YW-80-2 - \$176 HD-CP-80-2 - \$143
36" Door with Knob	HD-BW-60-3 - \$302 HD-YW-60-3 - \$302 HD-CP-60-3 - \$287	HD-BW-80-3 - \$321 HD-YW-80-3 - \$321 HD-CP-80-3 - \$306
60" Double Doors with Header	HD-BW-60-4 - \$311 HD-YW-60-4 - \$311 HD-CP-60-4 - \$270	HD-BW-80-4 - \$338 HD-YW-80-4 - \$338 HD-CP-80-4 - \$300
60" Double Doors Without Header	HD-BW-60-5 - \$282 HD-YW-60-5 - \$282 HD-CP-60-5 - \$242	HD-BW-80-5 - \$309 HD-YW-80-5 - \$309 HD-CP-80-5 - \$272
36" Slider with Header	HD-BW-60-6 - \$677 HD-YW-60-6 - \$677 HD-CP-60-6 - \$671	HD-BW-80-6 - \$692 HD-YW-80-6 - \$692 HD-CP-80-6 - \$689
36" Slider Without Header	HD-BW-60-7 - \$590 HD-YW-60-7 - \$590 HD-CP-60-7 - \$592	HD-BW-80-7 - \$606 HD-YW-80-7 - \$606 HD-CP-80-7 - \$614
72" Slider with Header	HD-BW-60-8 - \$1392 HD-YW-60-8 - \$1392 HD-CP-60-8 - \$1371	HD-BW-80-8 - \$1406 HD-YW-80-8 - \$1406 HD-CP-80-8 - \$1392

Post & Frame (PF) Pricing by LNFT

Panel	40"	60"	80"	84"	103"
Black Wire Mesh (BW)	\$79	\$90	\$101	\$105	\$112
Yellow Wire Mesh (YW)	\$79	\$90	\$101	\$105	\$112
Clear Polycarbonate (CP)	\$122	\$133	\$144	\$148	\$155

Post & Frame (PF) Door Pricing

Door	40"	60"	80"	84"	103"
36" Door with Header	PF-BW-40-1 - \$85 PF-YW-40-1 - \$85 PF-CP-40-1 - \$87	PF-BW-60-1 - \$80 PF-YW-60-1 - \$80 PF-CP-60-1 - \$70	PF-BW-80-1 - \$75 PF-YW-80-1 - \$75 PF-CP-80-1 - \$65	PF-BW-84-1 - \$96 PF-YW-84-1 - \$96 PF-CP-84-1 - \$86	PF-BW-103-1 - \$64 PF-YW-103-1 - \$64 PF-CP-103-1 - \$55
72" Double Doors Without Header	PF-BW-40-2 - \$178 PF-YW-40-2 - \$178 PF-CP-40-2 - \$112	PF-BW-60-2 - \$170 PF-YW-60-2 - \$170 PF-CP-60-2 - \$150	PF-BW-80-2 - \$157 PF-YW-80-2 - \$157 PF-CP-80-2 - \$144	PF-BW-84-2 - \$184 PF-YW-84-2 - \$184 PF-CP-84-2 - \$164	PF-BW-103-2 - \$188 PF-YW-103-2 - \$188 PF-CP-103-2 - \$130
36" Header Filler Panel	N/A	N/A	N/A	N/A	PF-BW-103-3 - \$110 PF-YW-103-3 - \$110 PF-CP-103-3 - \$134
72" Header Filler Panel	N/A	N/A	N/A	N/A	PF-BW-103-4 - \$171 PF-YW-103-4 - \$171 PF-CP-103-4 - \$216



Workplace hazards arise all the time. Exposed moving parts are just asking for trouble, even if employees follow procedure. Machines, such as drilling machines, power presses, circular saws, welding equipment, etc., all pose a potential threat to employees. Worker safety and wellbeing should be at the top of your priority list.



With Parco, Inc., your employees will be protected from moving parts and harmful machinery. We will provide you with a strong and durable barrier that can withstand repetitive motion and vibration of moving parts. You can also rest assured knowing that your pre-engineered safety guarding meets requirements with OSHA and ANSI.



Your frames and guards can be designed by Parco to fit your specific needs, eliminating the need for unit modification. Easy installation means less down time. The strength of our aluminum extrusions creates longer product life so you don't need to worry about frequent, costly upgrades.

Parco, Inc. Pre-Engineered Safety Guarding is:

- Quick to measure & price
- Easily customizable
- Less Labor Intensive
- Re-configurable
- Versatile
- Strong & secure
- Cost efficient
- Resistant to corrosion
- Modular
- Long lasting

DISTRIBUTED BY:



www.parco-inc.com
(800) 817-0617
9100 Front Street
Fort Wayne, IN 46818

